

Bike Sport Developments Ltd

Unit 3D Manor Business park, Grants Hill way, Woodford Halse, Northants, NN11 3UB - UK
Tel 0044 (0)1327 263942 – mail@bikesportdevelopments.co.uk / www.bikesportdevelopments.co.uk



Description

The RPM series of regulators are designed for either direct mounting within the fuel rail, or in-line mounting using the BD038 regulator housing.

The regulator comprises a sealing valve joined to an elastic membrane which by means of a compression spring compensates the pressure within the regulator, hence, adjusting the fuel flow.

The body and cover are made from stainless steel, as are all internal components in contact with fuel, with the exception of the membrane which is a reinforced vulcanised rubber.



Dimensions

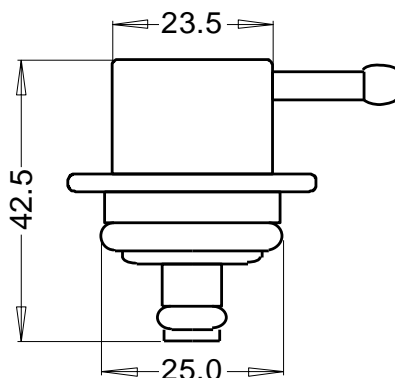

Technical Data

Weight..... 37 g
Flow range..... 5 > 300 l/h
Max vibration 30 g
Temperature range..... 0 > 100 °c
Filter mesh..... 150 µm

Pressure.....	RPM36	RPM40	RPM58	RPM72	RPM73	RPM74	
Nominal pressure.....	2.5	3.0	3.5	4.0	4.5	5.0	Bar
@ flow rate	40	40	40	80	80	80	Litres/hour
Methanol resistant	no	no	no	yes	yes	yes	

Ordering information

Part No.	Description
RPM 36	2.5bar regulator
RPM 40	3.0 bar regulator
RPM 58	3.5 bar regulator
RPM 72	4.0 bar regulator
RPM 73	4.5 bar regulator
RPM 74	5.0 bar regulator