

BD_SW_5B_SPx 5 button handlebar race switches

This switch set may be fitted to any race or road motorcycle. Four individual sealed switches are held in a machined aluminium enclosure offering high levels of crash protection as well as electrical integrity.

The user is free to choose the colour and type of switch in any of the 5 locations at the time of ordering except the centre switch that must be a momentary type due to switch length inside the housing.

Custom laser engraving is available as an extra cost, the default version has no markings to give the user greater freedom of use.

Although supplied without any connector, we can fit almost any connector as an extra cost.



Switch types

Fill in the form below using the choices indicated, the default selections are shown in (brackets).

- **Switch type** – Momentary or latching (note – momentary is normally open circuit)
- **Switch colour** – Black / Blue / Green / Red / White / Yellow

	Switch type	Colour
1		
2		
3		
4		
5		

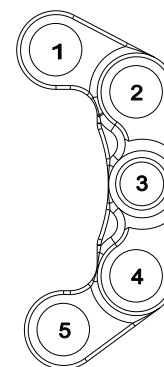

Each switch is independently wired and isolated from all other switches. Alternative wiring arrangements are available on request and at no extra cost.

Example layout

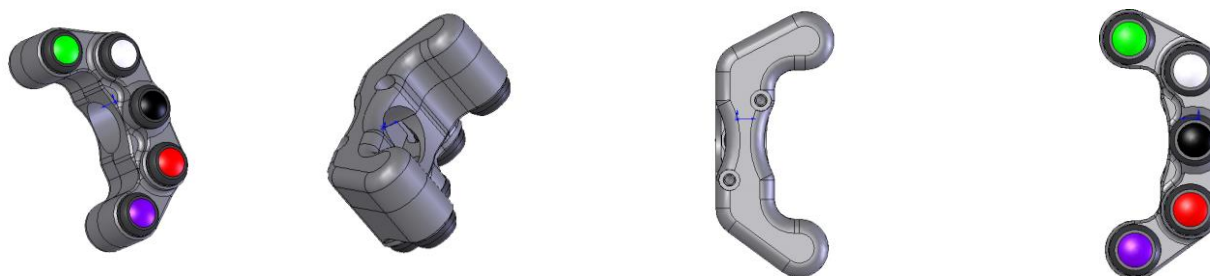

Electrical / Mechanical Characteristics

Wire..... Type 55 / 24
 Switch sealing..... IP67
 Housing..... Aluminium
 Coating..... Black anodise

Dia (handlebar)22mm (7/8")
 Engraving..... none
 Current3 Amp

Ordering Information

Part No.	Connector	Cable	Description
BD-SW-5B-SPx	none	500mm	5 way handlebar switch to suit all race motorcycles

For alternative switch arrangements and wiring please contact us:

- Single or dual pole switches
- Custom connectors
- 2,3 or 4 button switch sets
- Custom laser engraving