

**BD_SW_4B_01 4 button handlebar race switches
 Nemesis TCS**

This switch set has been created for users of the Nemesis TCS system on Ducati Superbikes 848/1098/1198 and Desmosedici. The assembly replaces the standard 2 way blue/green switch set as supplied with the TCS system and also provides two integral black buttons for controlling the dashboard Mode functions.

This assembly also has two connectors on flying leads, one to plug into the Nemesis TCS wiring, and one to plug into the standard bike loom for controlling the dash Mode. No modifications of the Nemesis or the bike wiring are necessary.



Function:

1	Green	TC – UP	Momentary
2	Black	Dash Mode – 1	Momentary
3	Black	Dash Mode – 1	Momentary
4	Blue	TC – Down	Momentary

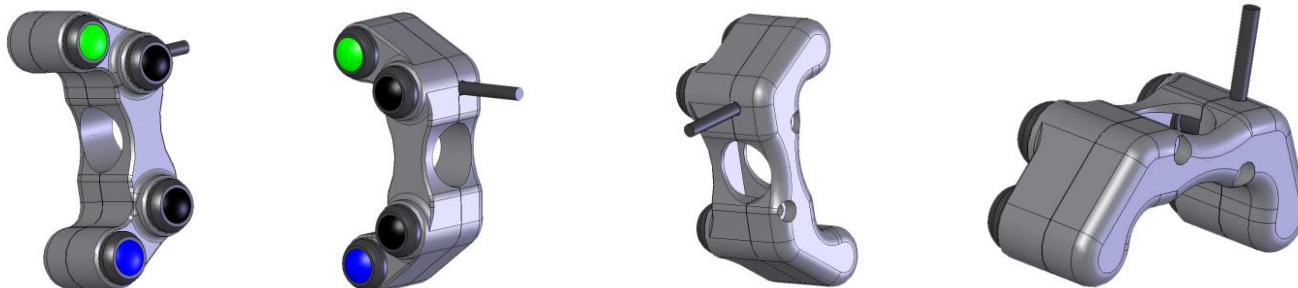
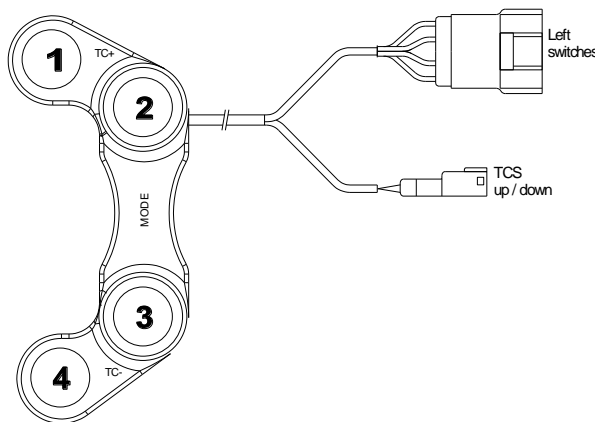

Electrical / Mechanical Characteristics

Wire..... Type 55 / 24
 Switch sealing IP67
 Housing.....Aluminium
 Coating..... Black anodise

Dia (handlebar)22mm (7/8")
 Total wire length – Mode..... 380 mm
 Total wire length – TCS 380 mm
 Length to Y junction from switch 200 mm

Ordering Information

Part No.	Connector	Cable	Description
BD-SW-4B-01	To suit application	See technical data	4 way handlebar switch to suit Nemesis TCS equipped Ducati superbike

For alternative switch arrangements and wiring please contact us:

- Latching or momentary switches
- Single or dual pole switches
- Custom wire lengths
- Custom connectors
- 2 button switch sets
- Custom laser engraving