

**BD\_SW\_3B\_07      3 button right side switch – Kawasaki ZX10-2016 , Run/Stop Starter , Lap-Start**

This switch is designed to replace the standard right side switch block on the ZX10-2016 bike

The aluminium assembly has been designed ultra-slim and encompasses these waterproof switches:

- RED latching (Push On , Push OFF) for stop and run
- Blue momentary to replicate the Lap time Start function
- Black momentary for engine starter



No modification of the bike wiring is necessary, this kit plugs directly into the 6 way connector of the standard loom,

This 3 way left switch can be used with the standard left side switch, or the matching 4 way race switch as seen here to the right– part number BD-SW-4B-09



**Function:**

1	Red	Stop /Run	latching
2	Blue	Lap - Start	Momentary
3	Black	Starter	Momentary

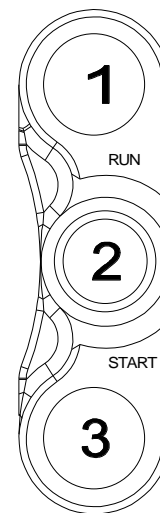
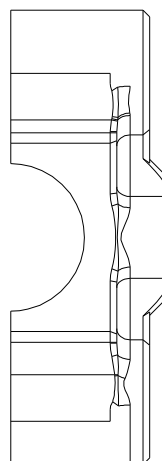

**Electrical / Mechanical Characteristics**

Wire..... Type 55 / 24  
 Switch sealing ..... IP67  
 Housing.....Aluminium  
 Coating..... Black anodise

Dia (handlebar) .....22mm (7/8")  
 Max width ..... 20.5 mm  
 Min width at centre ..... 14.5 mm  
 Weight ..... 85 g

**Ordering Information**

Part No.	Connector	Cable	Description
BD-SW-3B-07	To suit application	To suit	3 way handlebar switch for Kawasaki ZX10 - 2016